



Pond Road, London, E15

BUTLER & STAG



Guide Price £550,000 - £600,000
An extended three-bedroom period residence, beautifully positioned on the ever-popular Pond Road in Stratford is finished to a high standard throughout and features a desirable south-facing garden.



Freehold

- Period (Freehold) House - 808 Sq/Ft
- Three Bedrooms (Extended To Top Floor)
- Finished To A High Standard Throughout
- Two Bathrooms
- Sash Windows
- Secluded South Facing Garden
- Abbey Road DLR A Moments Walk Away
- Chain Free

This charming home offers modern living and well-balanced accommodation across three floors.

The ground floor comprises a spacious and inviting reception room, enhanced by tasteful décor, leading through to a stunning kitchen area. Designed with both style and functionality in mind, the kitchen boasts stylish indigo blue shaker cabinets, quality appliances, and ample workspace, with doors leading directly to a south facing garden.

Upstairs, three well-proportioned bedrooms provide comfortable accommodation, complemented by a contemporary bathroom finished to an excellent standard.

The standout south-facing garden is a true highlight, offering sun-filled outdoor space ideal for relaxing, gardening, or hosting guests.

Located within easy reach of Stratford's excellent transport links, including Abbey Road DLR (Dockland Light Railway), as well as a wide array of shops, cafés, and amenities, this exceptional home is perfectly suited to families and professionals alike.





Pond Road, E15

Approx Gross Internal Area : 75.1 sq m / 808 sq ft

BUTLER & STAG



Second Floor

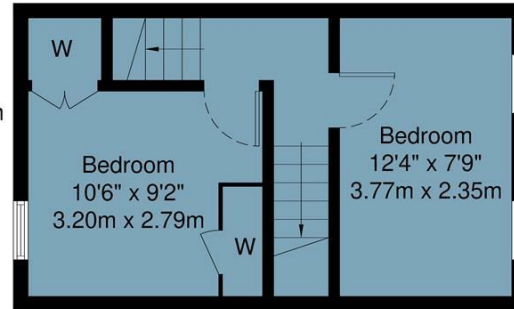

First Floor

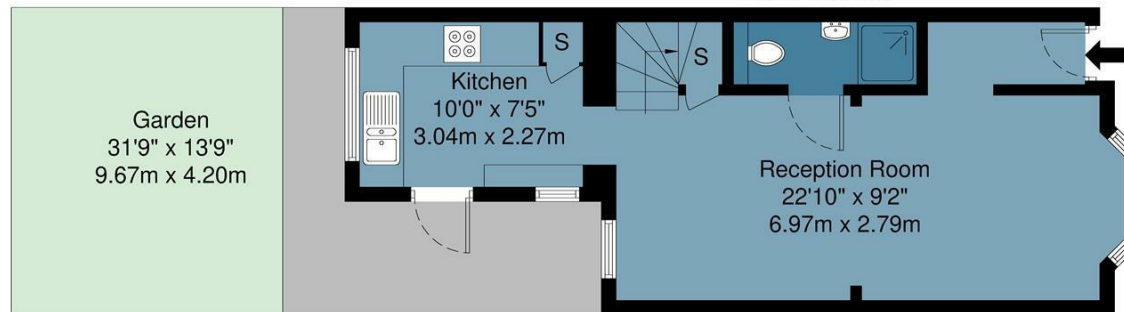

Ground Floor

Measurements are approximate and for illustration purposes only. While we do not doubt the accuracy and completeness, we advise you conduct a careful independent assessment of the property to determine monetary value.
© @ Maison VUE | www.maisonvue.com

BUTLER & STAG

☎ 020 8102 1236

🏠 508 Roman Road, Bow, London, E3 5LU

✉ bow@butlerandstag.com

IMPORTANT NOTICE - These particulars have been prepared in good faith and they are not intended to constitute part of an offer or contract. We have not performed a structural survey on this property and the services, appliances and specific fittings have not been tested. All photographs, measurements, floor plans and distances referred to are given as a guide and should not be relied upon.

www.butlerandstag.uk